



BALDOTA
Signature
2 & 3 BHK Luxury Apartment

PRM/KA/RERA/1251/446/PR/200123/003223



Live in your signature style !



BALDOTA
Signature
2 & 3 BHK Luxury Apartment

Open up to a new lyric called life!

Welcome an all new living experience called Baldota Signature! An experience brought alive by a combination of nature and in-vogue design concepts created by **MC Baldota Group**. Over years, MC Baldota Group have been enjoying a pioneering edge in devising new age designs drawing upon a wholesome threesome idea-Nature, perfect designs and a location that is second only to nothing.



MASTER PLAN

Experience the wide courtyard area...

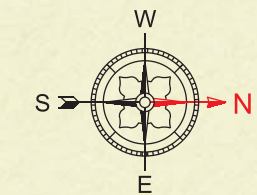

- 01 - Entry
- 02 - Exit
- 03 - Security Post
- 04 - Transformer Yard
- 05 - Cricket Pitch
- 06 - Jogging Track
- 07 - Pavilion Leisure
- 08 - STP
- 09 - Sitting Area
- 10 - Courtyard
- 11 - Gym
- 12 - Multipurpose Court
- 13 - Kids Play Area
- 14 - Swimming Pool
- 15 - Toddlers Pool
- 16 - Ramp Entry
- 17 - Ramp Exit
- 18 - Lifts

BALDOTA
Signature
 2 & 3 BHK Luxury Apartment



3 BHK

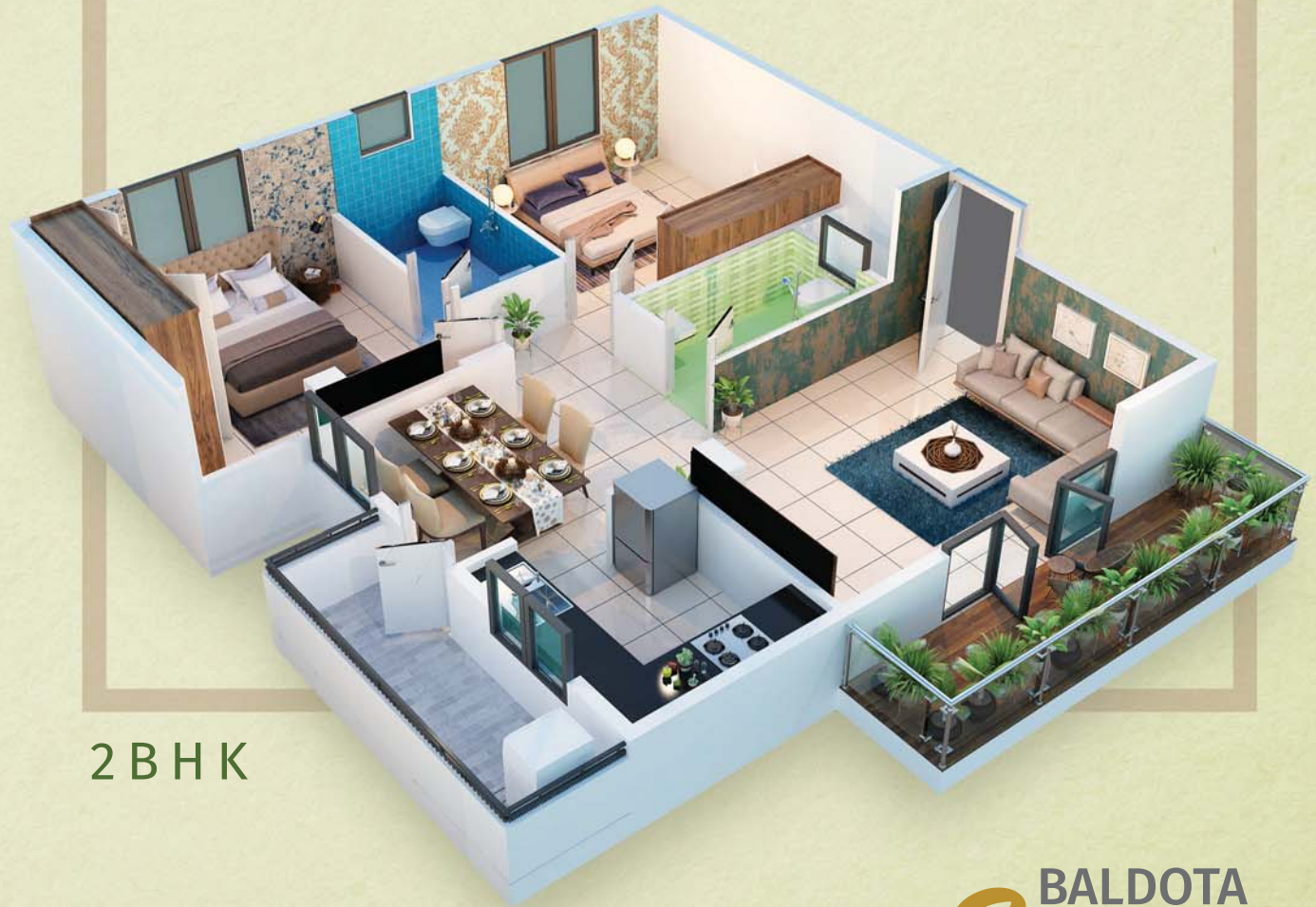

2 BHK

BALDOTA
Signature
2 & 3 BHK Luxury Apartment

TYPICAL FLOOR PLAN : A WING

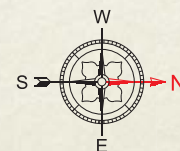



Typical Floor Plan : B WING

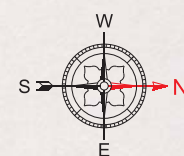

BALDOTA
Signature
 2 & 3 BHK Luxury Apartment



BALDOTA
Signature
2 & 3 BHK Luxury Apartment

Feel the symphony of space

At Baldota Signature, you experience the magic of spaces designed holistically, each and every element exemplifies a profound understanding of your lifestyle preferences. Combining insights from Vasthu, the centuries-old science of designing spaces, contemporary fine-living concepts and prevailing trends, the interior spaces bestow a unique feel-good, feel-at-home aspect-something that makes living at Baldato Signature a matter of opening your senses and heart to an all new you, and trust us, you'll find in living an opus harmony.

AMENITIES



- ☞ Children's Play Area
- ☞ Landscaped Area
- ☞ Party Hall
- ☞ Gymnasium / Yoga Room
- ☞ Swimming Pool & Toddler's Pool
- ☞ Senior Citizen Area
- ☞ Multi-purpose Court (Tennis/Shuttle)
- ☞ Cricket Pitch
- ☞ Jogging Track
- ☞ CCTV
- ☞ Intercom
- ☞ 24hrs. Security
- ☞ Power Backup
- ☞ Rain water harvesting
- ☞ STP



Working out hard or simply bubbling fun around,
live the day, absolutely your way...

One needs to check our range of amenities to understand that happiness is an absolute feeling. Perhaps for the first time, you'd think of trying something new, just as you'd rediscover newness in everything you did so far. Be it hitting our well equipped gym, jeer-cheering at the club or sitting at the park overhearing the whispers of nature..

SPECIFICATIONS



Structure
RCC framed Structure.



Walls
6" thick Cement concrete solid blocks for exterior walls & 4" thick Cement concrete solid blocks for interior walls



Windows
3 track UPVC frame with UPVC glass sliding shutters provision for "Mosquito mesh", MS safety grills. for kitchen/utility aluminium windows Sliding Doors (Balcony) 3 track UPVC frame with UPVC glass sliding shutters provision for "Mosquito mesh".



Kitchen Platform
Granite platform with Steel sink, 2' height ceramic tiled dado on cooking platform.



Doors
Main Door Teak wood frame with Moulded panel shutter Internal doors Salwood frame with moulded panel shutters



Lift
Lift of KONE/Johnson/OTIS or equivalent.



Car Parking
Covered car parking.



Painting
Asian/Sherwin William/Berger, or Equivalent emulsion paint for interiors, Exterior emulsion paint for exterior.



Electrical Work
Anchor wiring with good quality switches. AC point for Master bedroom Aqua guard & washing machine points.



T.V. & Telephone
T.V. & Telephone point in Living & Master bedroom.



Flooring
Vitrified tiles for entire flat & Ceramic tiled flooring for utility.



Toilet
Anti-skid Ceramic tiled flooring & glaze tile dado upto door height.



Water Supply
Water supply from Borewell.



Sanitary
Jaquar/Equivalent CP fittings & Somany/CERA/Equivalent sanitary ware.



Power Backup
Generator for Lift, Motors & Common area lighting, 1 KVA Power backup for each flat.



Intercom
Intercom facility for all flats, connecting to security.



The location you always preferred.
The conveniences you always desired.

Baldota Signature located at, the most happening and sought-after spot ever in Bengaluru, Baldota Signature brings a world of luxury and lifestyle at your bid. With a lot of prestigious schools, acclaimed hospitals, shopping malls and famous social hot-spots and places of worship surrounding you, you will find work-life harmony at its best. Though centrally located, the project is safely away from the din and bustle. The spatial planning and distribution is worked out in such a way that the occupants ever get affected by the huff and puff outside.

BALDOTA
Signature
2 & 3 BHK Luxury Apartment



LOCATION MAP

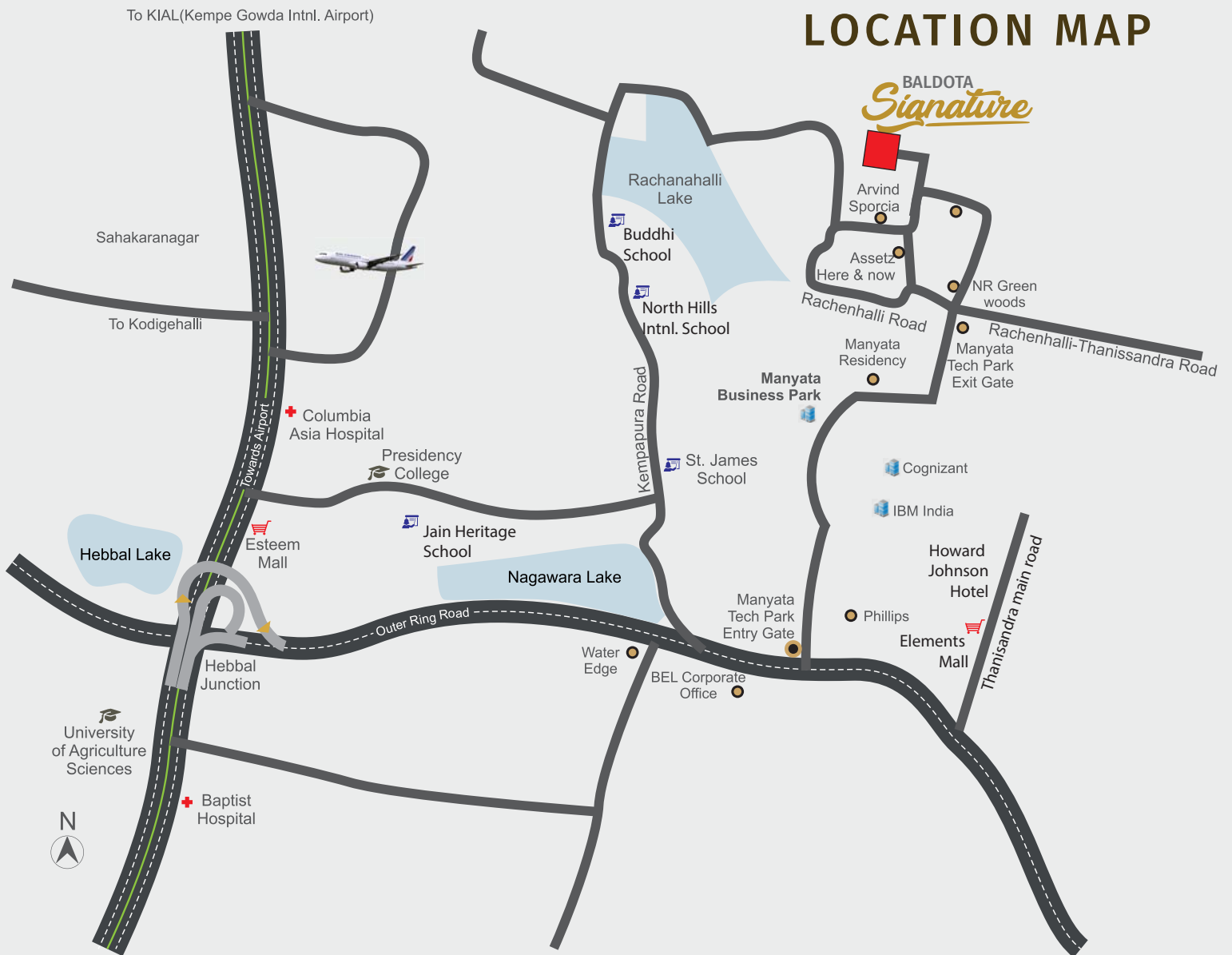

Neighbourhood

Educational Institute

Innovious E-Techno School & PU College
 North Hills Intl. School
 Jain Heritage School
 Bangalore Group of Institutions
 KNS Institute of Technology
 Vidya Niketan School
 Sindhi PU College
 Narayana PU college

Hospital

Columbia Asia
 Aster CMI Hospital
 Regal multi speciality HOSPITAL
 Sai Hospital
 Prolife Hospital

Hotel & Malls

White Castle Hotel
 Courtyard by Marriott
 Treebo Trip Jade Blue Suites
 Country Inn & Suites by Radisson
 Esteem Mall
 Elements Mall

IT Parks

Karle Special Economic Zone
 Manyata Embassy Tech Park
 Newbridge Business Centre
 Cognizant
 L&T Tech Park

A Project by



Baldota

Baldota Builders & Developers

#34/1 1st Main Road Kalidasa Marg, Keshav Niwas
 3rd Floor, Gandhinagar, Bangalore - 560009

Mob : +91 9900011782, 9535357222

Mail : baldotabuildersanddevelopers@gmail.com

Architect :

YUKTI ARCHITECTS
 ARCHITECTURE · ENGINEERING · INTERIORS

Legal Advisor :



SUNDARASWAMY & RAMDAS ADVOCATES